

REVISIONS			
10/14/24	REV	PER	SP-DRC
12/19/24	REV	PER	SP-DRC

JEH

Jeff H. Irvani, Inc.

Consulting Engineers

1934 COMMERCE LANE, SUITE 5
JUPITER, FLORIDA 33458
TEL: (561) 575-6030
FAX: (561) 575-6088
JHI@jhinc.com
www.jhinc.com

201 SW 12th Ave

Pompano Beach, Florida

Pavement Marking & Signage Plan			
DATE	SCALE	DESIGNED BY	JOB NO.
08/05/2022	1"=20'	JBI	2208-1411

SEAL	
CDA # 6986	
SHEET NO.	
C-2	

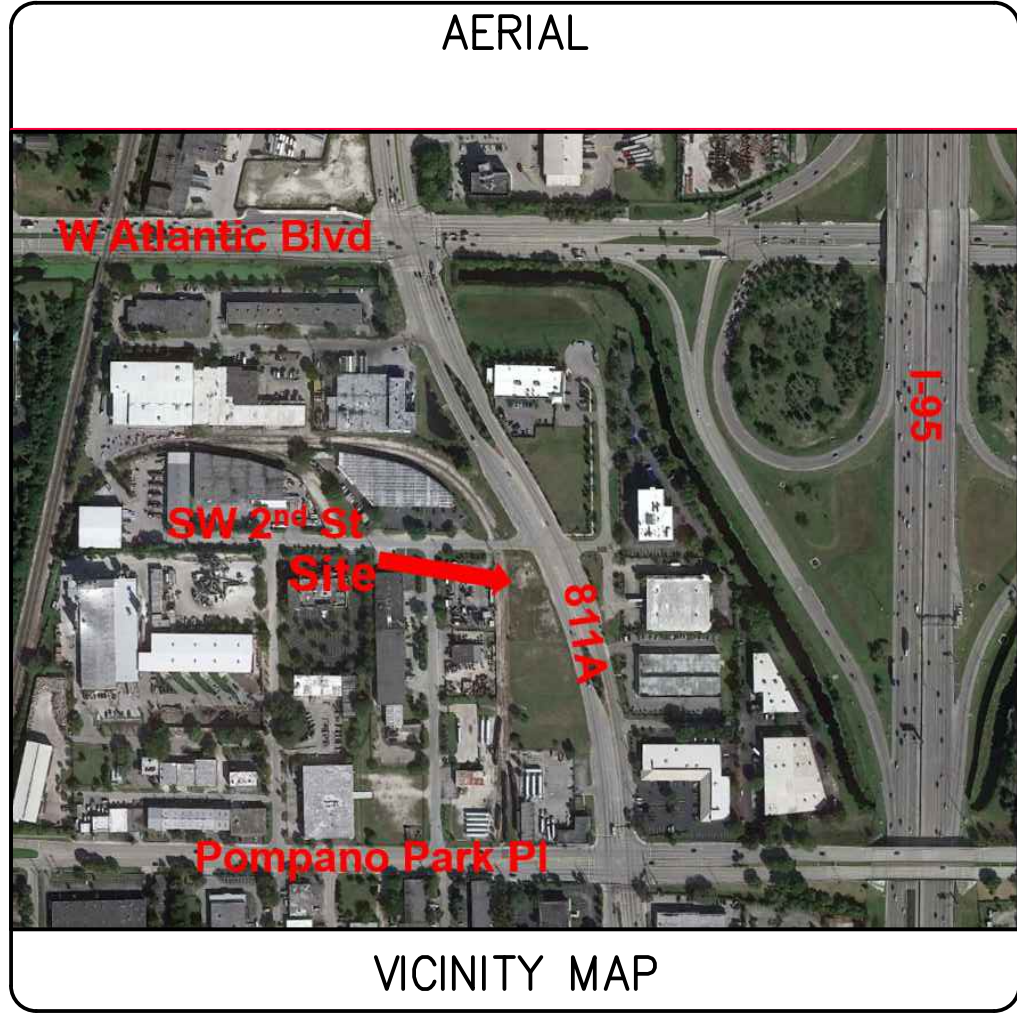

VICINITY MAP

SECTION 2 TOWNSHIP 49S RANGE 42E

Permit Set, Not for Construction/Bidding

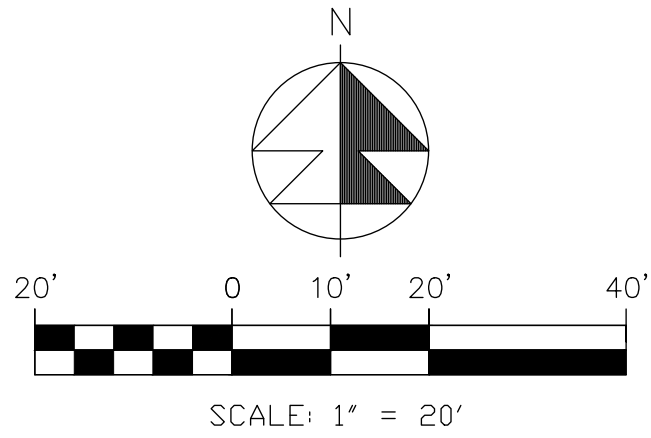

- NOTES:
- 19"-24" DEEP ROOT BARRIERS MUST BE INSTALLED ALONG ALL CURBS & SIDEWALKS WITHIN 10' OF EXISTING OR PROPOSED TREES. (SEE LANDSCAPE PLANS)
 - SURVEYOR SHALL VERIFY ALL DIMENSIONS PRIOR TO STAKING & INFORM THE ENGINEER OF RECORD OF ANY DISCREPANCIES.
 - ALL DETECTABLE WARNINGS SHALL BE CONSTRUCTED IN ACCORD W/ 2010 USDOJ ADA REQ'S, 2010 FBC & 2020 FDOT DESIGN STD'S INDEX 522-002.
 - ALL HANDICAP RAMPS SHALL BE IN ACCORDANCE WITH FDOT DESIGN STANDARDS #522-002.
 - ALL PAVEMENT MARKINGS AND SIGNAGE, INCLUDING THE SUPPORT POSTS, SHALL CONFORM TO "BROWARD COUNTY TRAFFIC ENGINEERING DIVISION STANDARDS" (BCTED) AND "THE MANUAL ON UNIFORM TRAFFIC CONTROL DEVICES" (MUTCD) STANDARDS.
 - ALL MARKINGS SHALL BE THERMOPLASTIC MATERIAL MEETING THE BCTED AND FDOT STANDARDS, EXCEPT FOR THE PARKING SPACE MARKINGS WHICH MAY BE REFLECTORIZED PAINT MEETING THE BCTED STANDARDS AND FLORIDA DEPARTMENT OF TRANSPORTATION (FDOT) SPECIFICATIONS FOR "STANDARD PAINT".
 - PAVEMENT MARKINGS AND SIGNAGE FOR ALL ACCESSIBLE PARKING SPACES SHALL BE IN ACCORDANCE WITH THE FLORIDA DEPARTMENT OF TRANSPORTATION (FDOT) "STANDARDS PLANS", INDEX NOS. 711-001 AND 700-102 AND LATEST CITY STANDARD REQUIREMENTS.
 - ALL PARKING SPACES MUST HAVE A PAVEMENT MARKING ON EACH SIDE OF EACH SPACE TO IDENTIFY THE LIMITS OF THE SPACE.
 - ALL SIDEWALK CURB RAMPS 5' OUTSIDE AND BEYOND THE BUILDING ENVELOPE SHALL BE PER FDOT "STANDARD PLANS", INDEX NO. 522-002.
 - ALL ACCESSIBLE PARKING SPACES, ACCESSIBLE PARKING ACCESS AISLES, SIDEWALK CURB RAMPS, ACCESSIBLE ROUTES AND RAMPS MUST BE ADA COMPLIANT PER FLORIDA BUILDING CODE, SIXTH EDITION, "ACCESSIBILITY".
 - ALL ACCESSIBLE PARKING SPACES, ACCESSIBLE PARKING ACCESS AISLES, SIDEWALK CURB RAMPS, ACCESSIBLE ROUTES AND RAMPS SHALL BE FIELD CHECKED AT THE TIME OF FINAL INSPECTION TO CONFIRM COMPLIANCE WITH ADA STANDARDS/REQUIREMENTS, INCLUDING SLOPING. NON-CONFORMING ACCESSIBLE PARKING SPACES, ACCESSIBLE PARKING ACCESS AISLES, ACCESSIBLE ROUTES AND RAMPS WILL BE REQUIRED TO BE CORRECTED FOR ACCEPTANCE OF THE PERMITTED WORK AND CLOSE-OUT OF THE ENGINEERING CONSTRUCTION PERMIT.
 - ALL VEHICULAR TRAFFIC/PEDESTRIAN PAVEMENT MARKINGS AND SIGNAGE WITHIN THE PROJECT LIMITS SHALL BE FIELD CHECKED AT THE TIME OF FINAL INSPECTION TO CONFIRM COMPLIANCE WITH BCTED/CITY STANDARDS/REQUIREMENTS. ALL NON-CONFORMING PAVEMENT MARKINGS AND SIGNAGE, INCLUDING THE SUPPORT POSTS, WILL BE REQUIRED TO BE REPLACED FOR ACCEPTANCE OF THE PERMITTED WORK AND CLOSE-OUT OF THE ENGINEERING CONSTRUCTION PERMIT.
 - PER COMMUNICATION WITH FPL, THERE IS A PERPETUAL LICENSE WITH THE CITY IN REGARDS TO THE OVERHEAD WIRES. THERE IS NO EXPIRATION DATE AND WILL REMAIN VALID INDEFINITELY.

- SIGN NOTES:
- STOP SIGN, R1-1, SIZE SHALL BE 30"x30"
 - DO NOT ENTER SIGN, R5-1, SHALL BE 30"x30"

- CONST 2" ASPHALT PAVEMENT
- CONST 4" CONCRETE
- EXIST CONCRETE

LEGEND	
000.0	PROP PAVT EL
00.0	PROP CONC SW EL
00.0	EXIST EL
00.0	CONTRACTOR TO FIELD VERIFY
00.0	INVERT EL
00.0	CATCH BASIN
00.0	YARD DRAIN
00.0	BOTTOM EL
00.0	TOP EL
00.0	EXFILTRATION TRENCH
00.0	WATER MAIN
00.0	WATER SERVICE
00.0	SANITARY SERVICE
00.0	FORCE MAIN
00.0	FIRE MAIN
00.0	UNDERGROUND WIRE
00.0	STORM LINE
00.0	WASTEWATER GRAVITY
00.0	FIRE HYDRANT
00.0	POST INDICATOR VALVE
00.0	GATE VALVE
00.0	TAPPING VALVE
00.0	VALVE
00.0	FIRE DEPT CONNECTION
00.0	CV CHECK VALVE
00.0	DDCA-DBL OHK DETECTOR ASSEMBLY
00.0	RPDA-REDUCED PRESS DET ASSEMBLY
00.0	WATER METER W/ REDUCED PRESSURE BACKFLOW PREV.
00.0	SAMPLE POINT
00.0	MITERED END SECTION
00.0	FIN FLOOR ELEV
00.0	FLOW LINE ELEV
00.0	TOP OF BANK
00.0	TOP OF SLOPE
00.0	TOP OF CONCRETE
00.0	TOP OF FINISH
00.0	UTILITY EASEMENT
00.0	DRAINAGE EASEMENT
00.0	LANE MAINTENANCE EASMT
00.0	LIMITED ACCESS EASMT
00.0	CLEANOUT
00.0	BORING NO. AND LOCATION
00.0	ELLIPITICAL RCP
00.0	REINFORCED CONC PIPE
00.0	CORRUGATED ALUMINUM PIPE
00.0	HDPPE
00.0	POLYETHYLENE PIPE
00.0	CORRUGATED METAL PIPE
00.0	PROP CONC EL

48 HOURS BEFORE DIGGING
CALL TOLL FREE

811
CALL SUNSHINE
NOTIFICATION CENTER

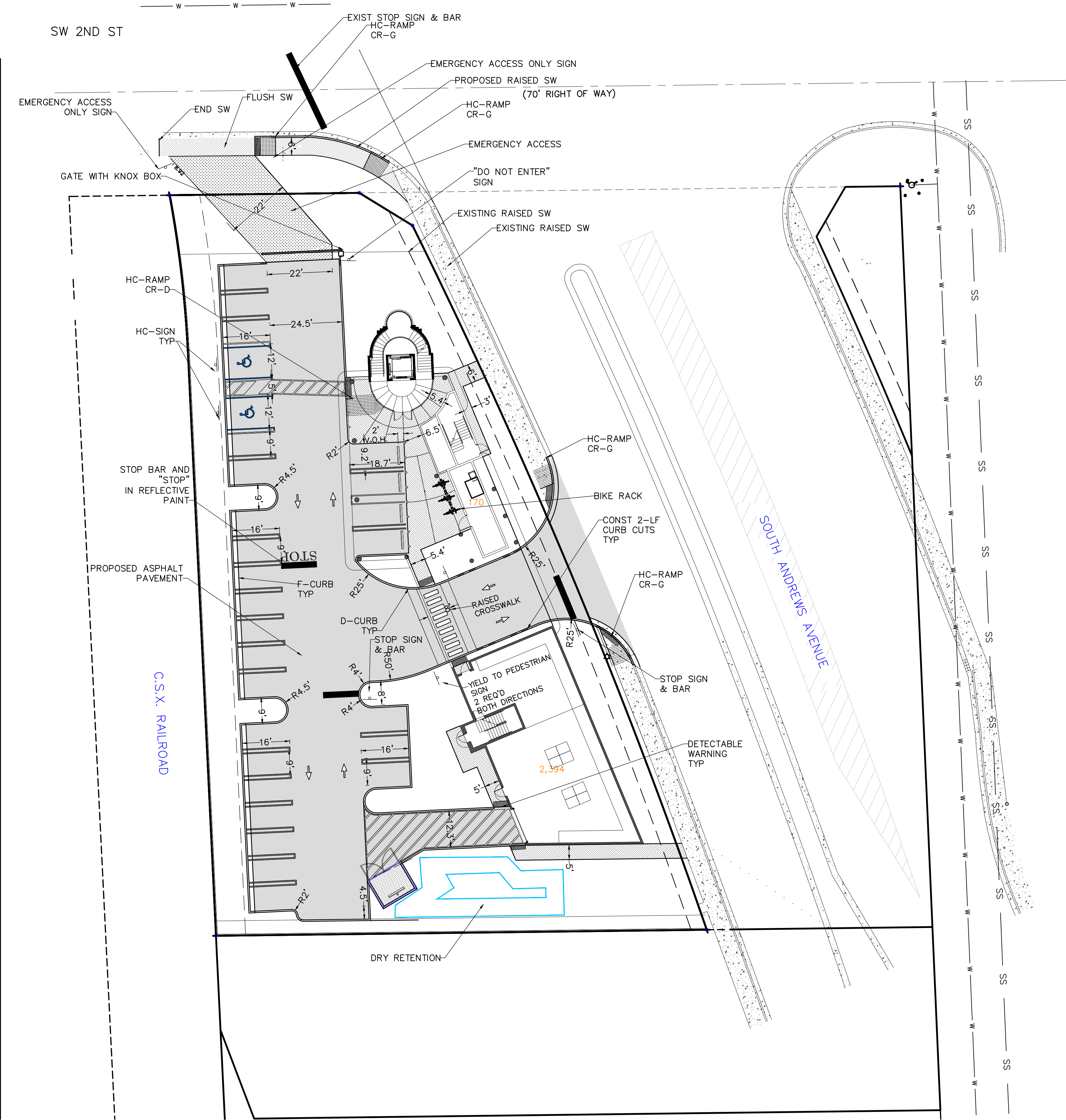

AAC

PZ22-12000026

12/23/2024